



# Safety Instructions



0, 1, 6, 8, 11, 12, 15,  
22, 23, 25, 28



+49 (0) 5041 998 389

Mon. - Do. 7<sup>00</sup> - 20<sup>00</sup>

Fr. 7<sup>00</sup> - 17<sup>00</sup>

Paulmann Licht GmbH  
31832 Springe / Germany  
www.paulmann.com

Art.-Nr.:  
701.96/97/98 702.05/  
06/07/08/09/10/11/52  
53/54/55/56/57/703.09/  
10/11/12/17/18/20/21  
32/33/36/37/38 704.07  
/08/31/36/62/82/83/84  
/85 705.02/03/04/05/  
06/07/92/93/94  
(+MA 173)   
POW 12/14

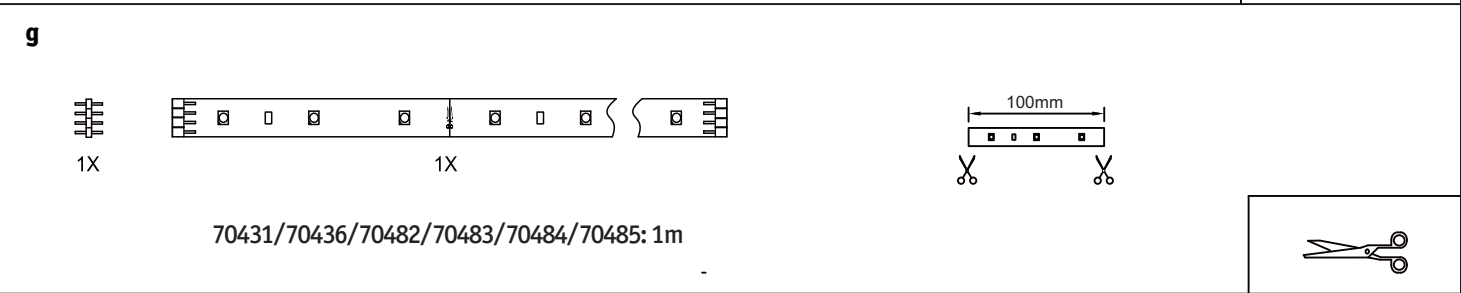
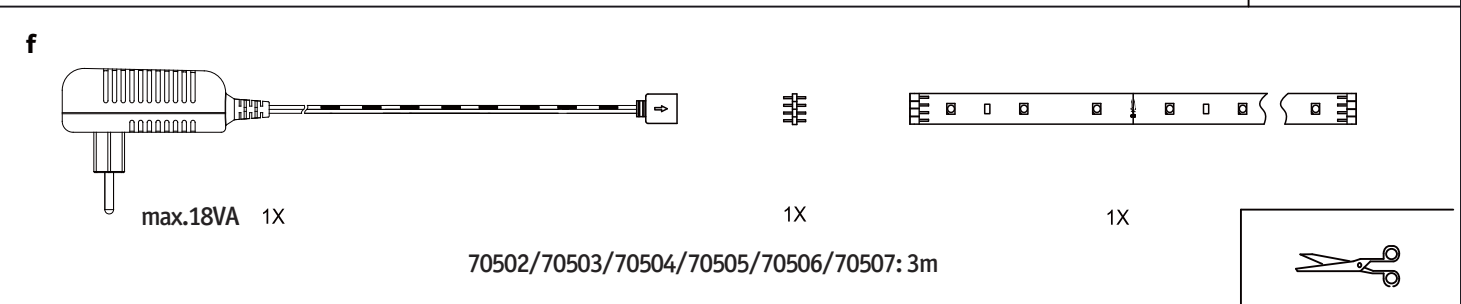
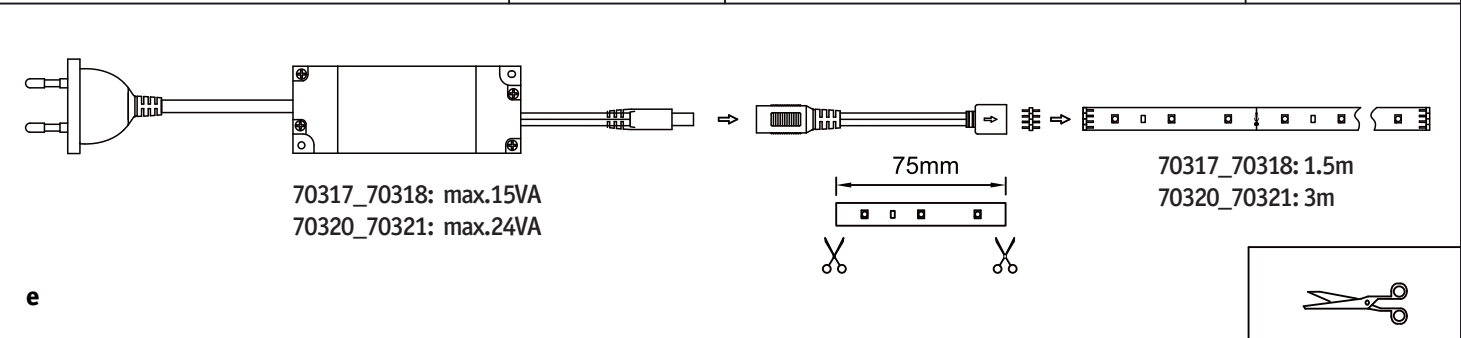
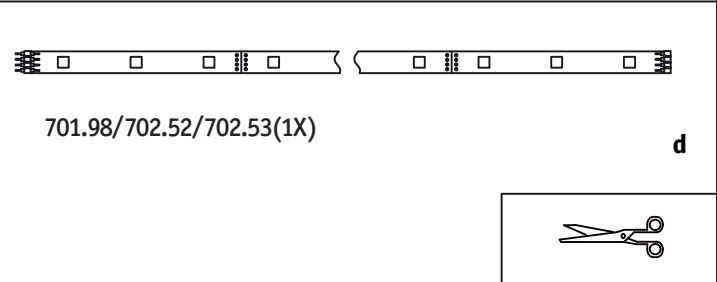
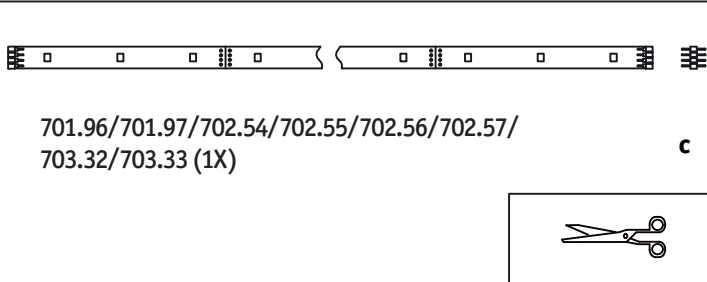
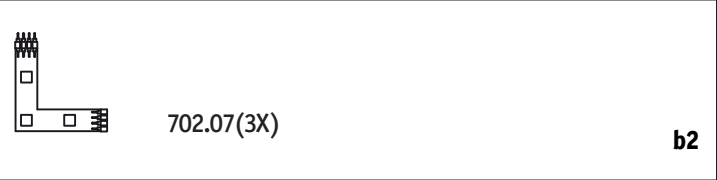
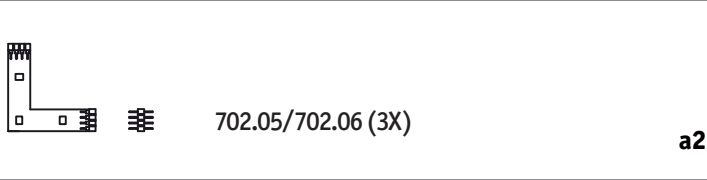
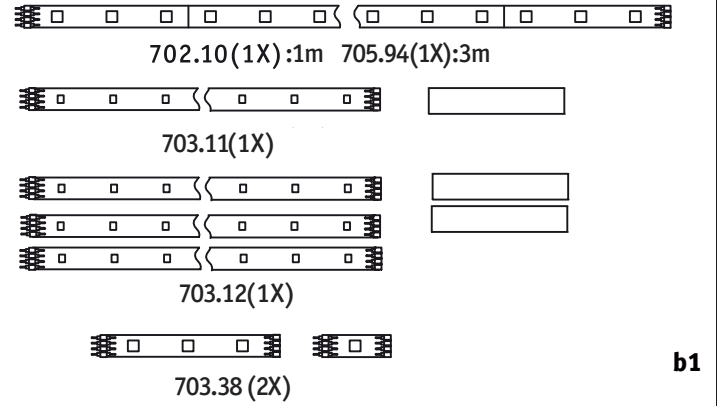
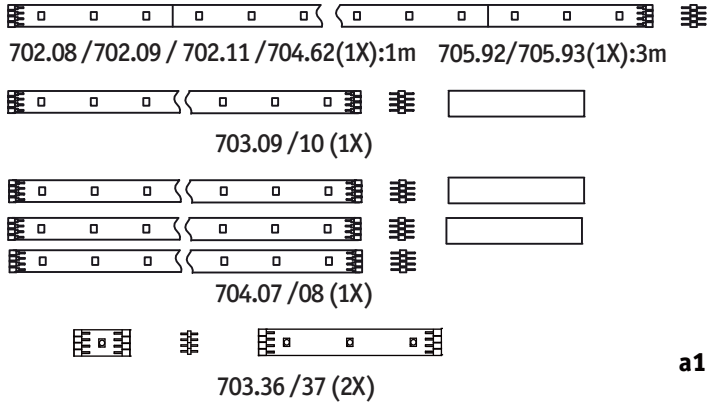

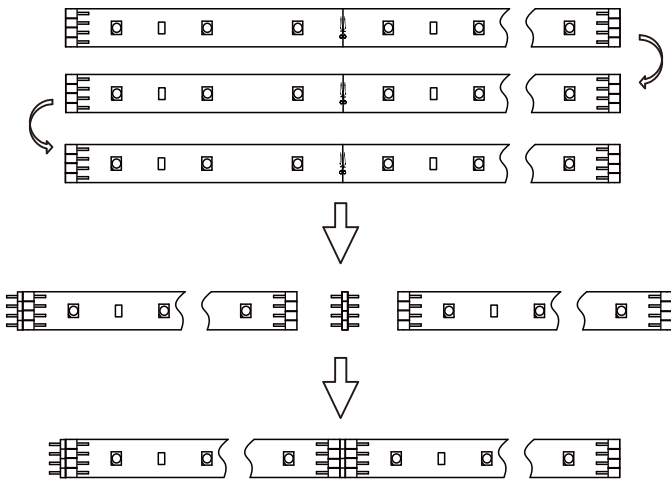
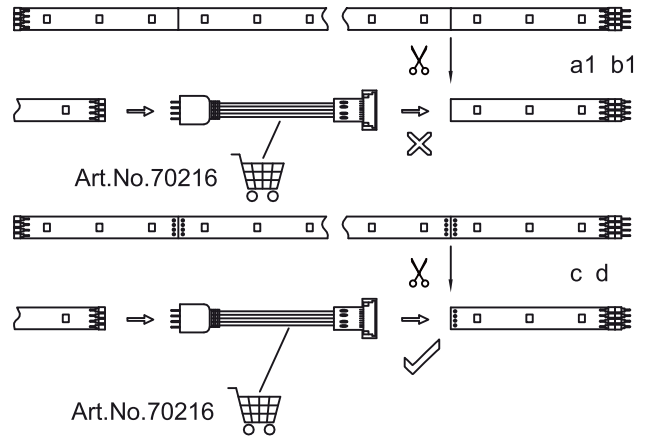
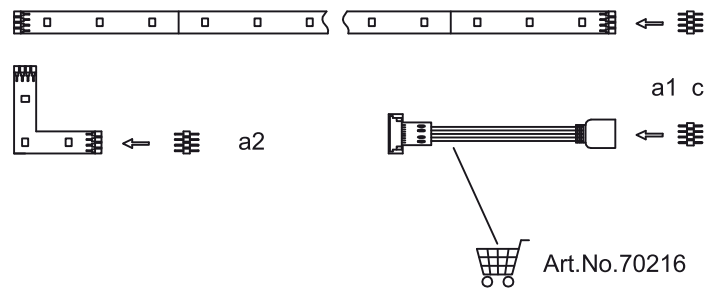
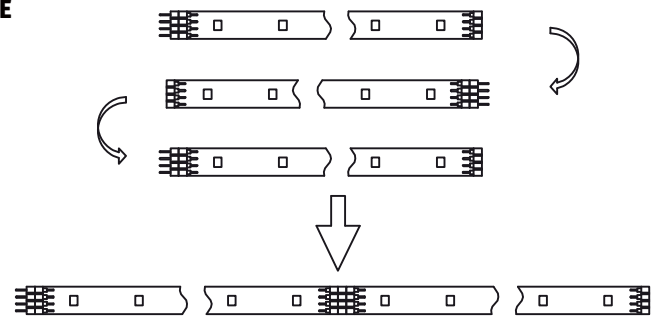
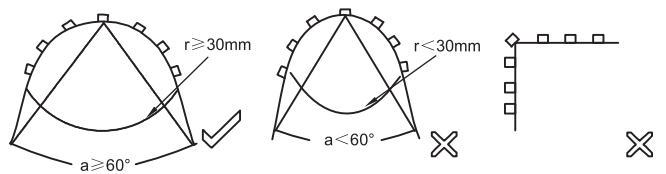
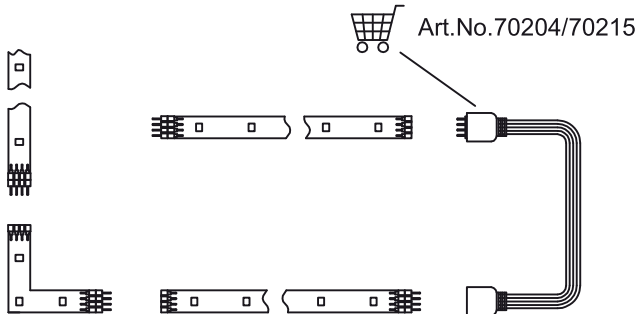
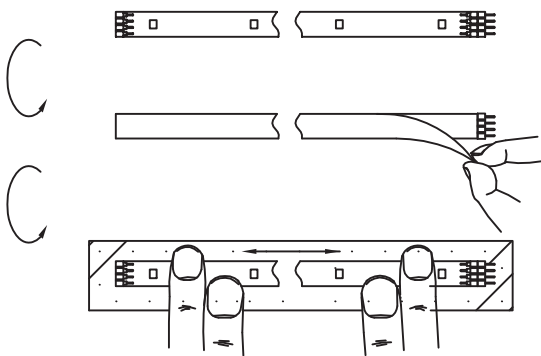
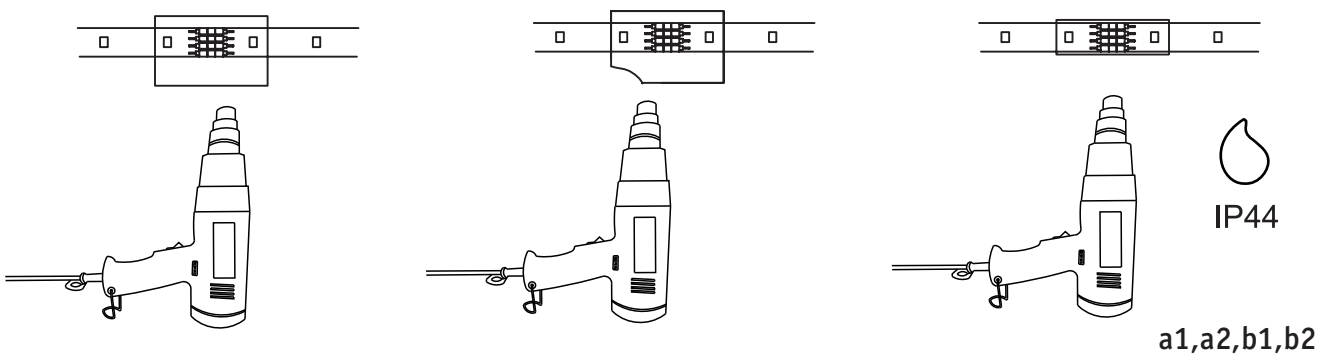
**A****B****D****E****G****C****F****H**

I

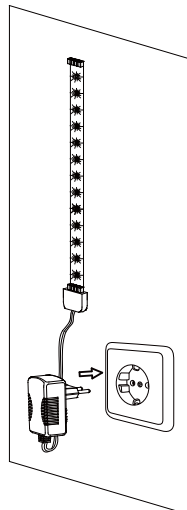

70485/70431 / 70436 / 70482 / 70483/ 70484  
70502 / 70503/ 70504 / 70505/ 70506/70507

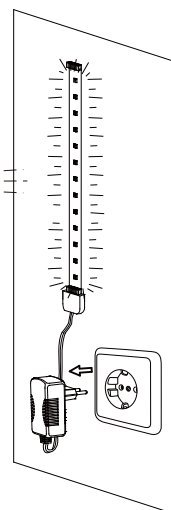
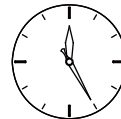

70431 / 70436 / 70482 / 70483/ 70484  
70503/ 70504 / 70505/ 70506/70507

J

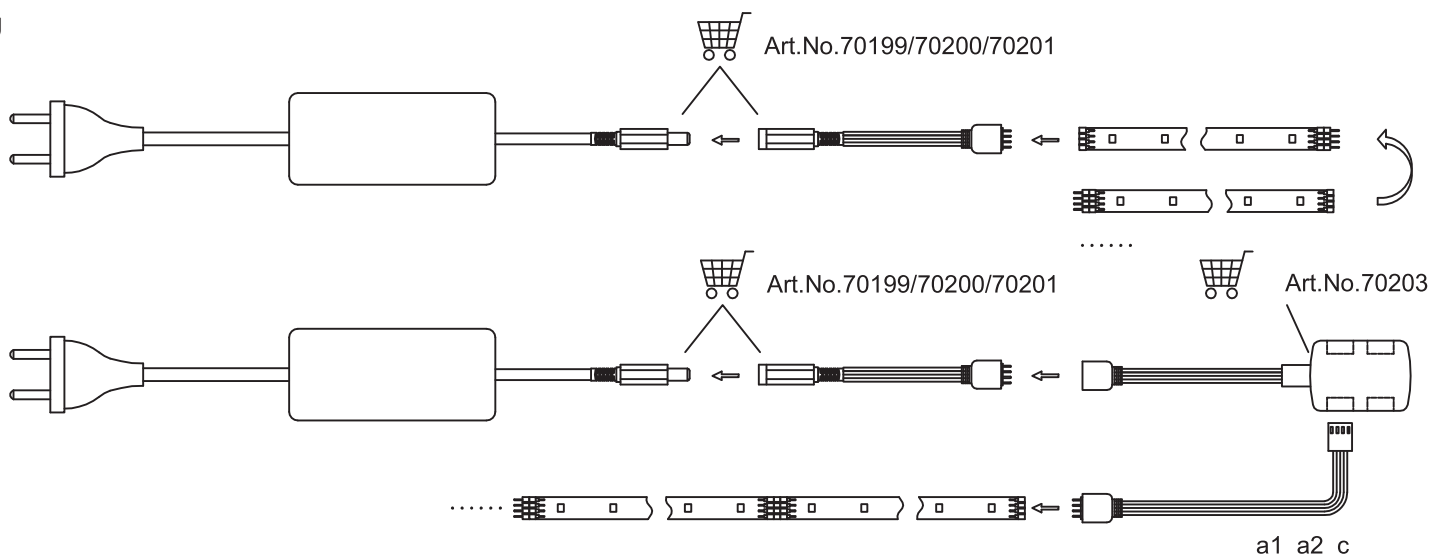

K

